



TS-905E

IP PoE Surveillance Microphone

SPON IP PoE Surveillance Microphone TS-905E is suitable for Financial, Judicial, Public Security, Safe City, Inspection and other occasions of sound collection. Can be connected to the hard disk recorder, user can preview playback IP network pickup audio and video synchronously in the hard disk recorder.



Voice Alarm

Built-in AGC

MAIN FEATURES

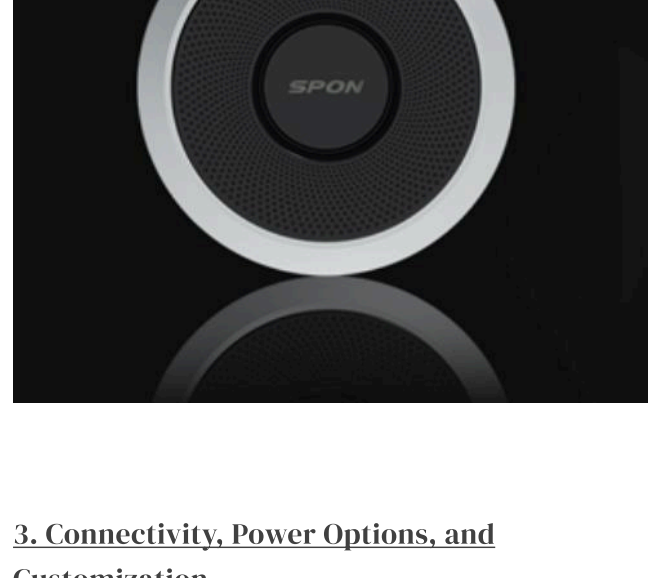

1. Robust Design and Material Quality

-Metal structure with a diamond net cover and an oxidized aluminum alloy shell, offering corrosion resistance and easy installation

2. Advanced Audio Technology

- Adaptive dynamic noise reduction with a built-in high-speed DSP for strong output.

- High sensitivity, full directional capacitive microphone for omnidirectional sound collection, ensuring clear and natural sound.

- Built-in automatic AGC for balanced sound across distances.

3. Connectivity, Power Options, and Customization

- Ultra-long sound Collecting range with strong anti-interference ability and convenient wiring.

- Customizable alarm output interface that triggers based on environmental noise decibel levels.

- Dual power supply options: power adapter and POE.

- Supports remote management and online upgrades for continual improvement.

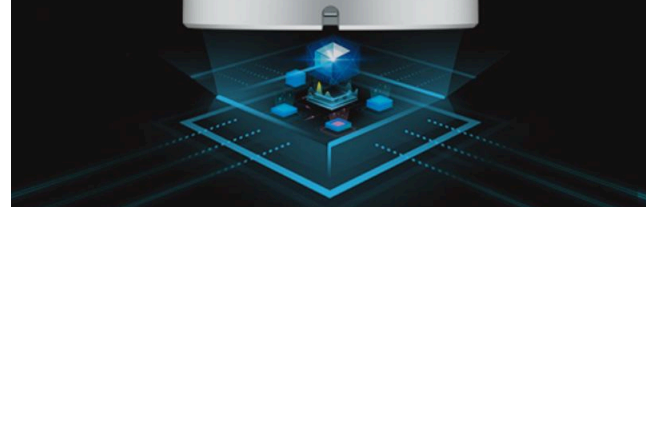

01

SPECIFICATION

POWER PARAMETERS

Power Supply: DC 12V , PoE (IEEE 802.3at/af)

MIRCOPHONE PARAMETERS

Sound Pickup Range: 5-180m(Adjustable)

Directional Property: Omnidirectional

Signal Output Amplitude: ≤1Vrms

Sensitivity: ~35dB

SNR: 90dB(@1KHz)

Frequency Response: 20Hz~20KHz

NETWORK PARAMETERS

Network I/F 10BASE-T/100BASE-TX RJ45

Network Protocol HTTP,TCP/IP,UDP,ARP,ICMP,IGMP

Configuration Method Web Interface

MECHANICAL&ENVIRONMENT PARAMETERS

Mounting Method Ceiling Mount

Installation Environment Dry Indoor Environment

Operating Temperature -20°C~+60°C

Shell Material Aluminium Alloy

Product Dimensions Φ85*18 (Mm)

Product Warranty 2 Years Limited

ACCESSORIES

1×Waterproof Tail Wire

3×Plastic Expansion Sleeve (F7)

3×Half Round Head Cross Screw (4*20)

1×Terminal Block (3.81-4P)

1×Mounting Base

1×Certificate Of Quality And Warranty Card

1×Quick Install Guide

02

PORTS DESCRIPTION

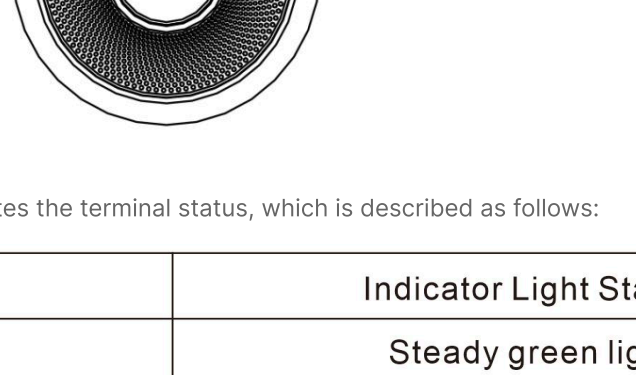

②Status Light: Indicates the terminal status, which is described as follows:

Terminal Status	Indicator Light Status
Power on	Steady green light
Login Platform	Green light keeps on for 5 seconds and then turns off for 500ms ,Loop
Pull Stream	Green light slow flash
Work abnormal	Green light fast flash

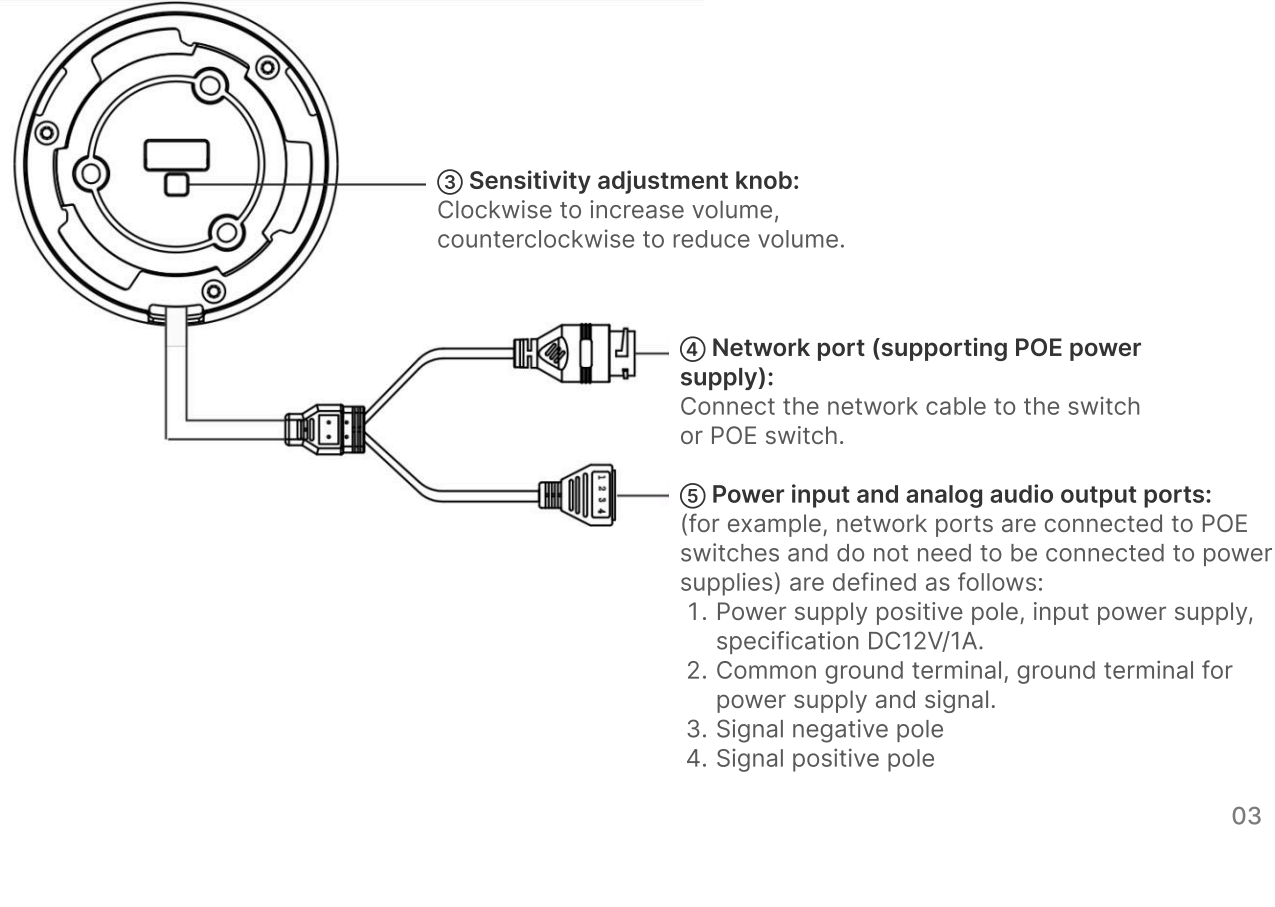

03

CONNECTION DIAGARM

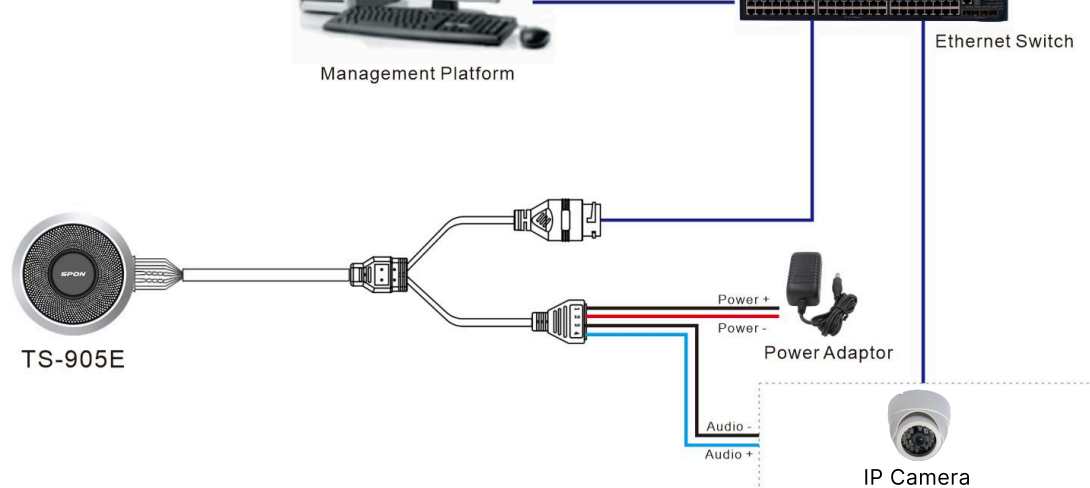

APPLICATION

IP PoE Surveillance Microphone TS-905E can be connected to IP camera for audio and video recording . Meanwhile , it can be customized with an alarm output which can be connect to the third-party alarm system ,when it detect the ambient noise exceeds a certain decibel value ,it will give an relay output .

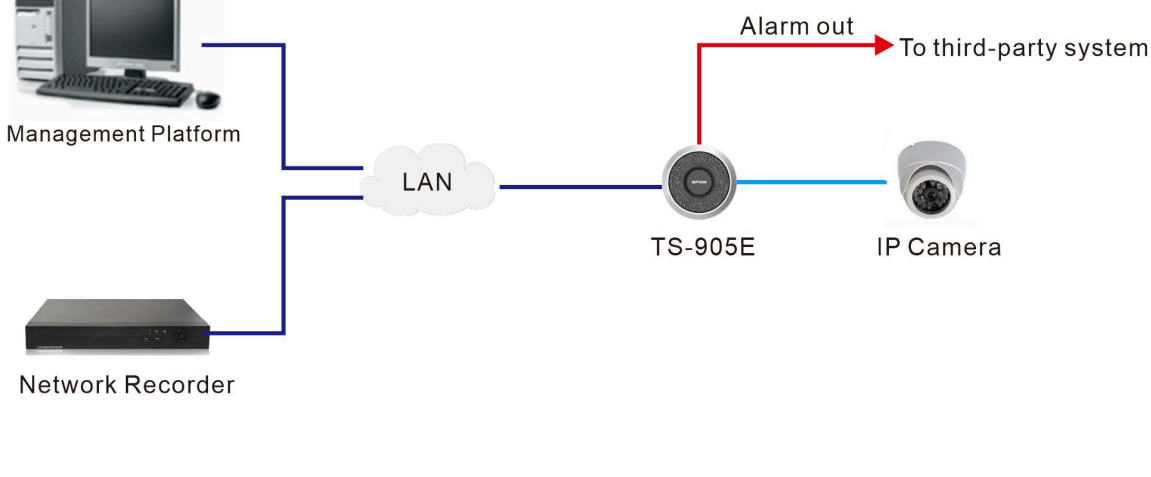

04

INSTALLATION

Installation instructions: Fix the pickup base on the wall with self-tapping screws and plastic expansion sleeve in the accessories, align the pickup notch with the base buckle, and rotate it in the direction indicated in the picture until a click is heard, indicating that the installation is in place.

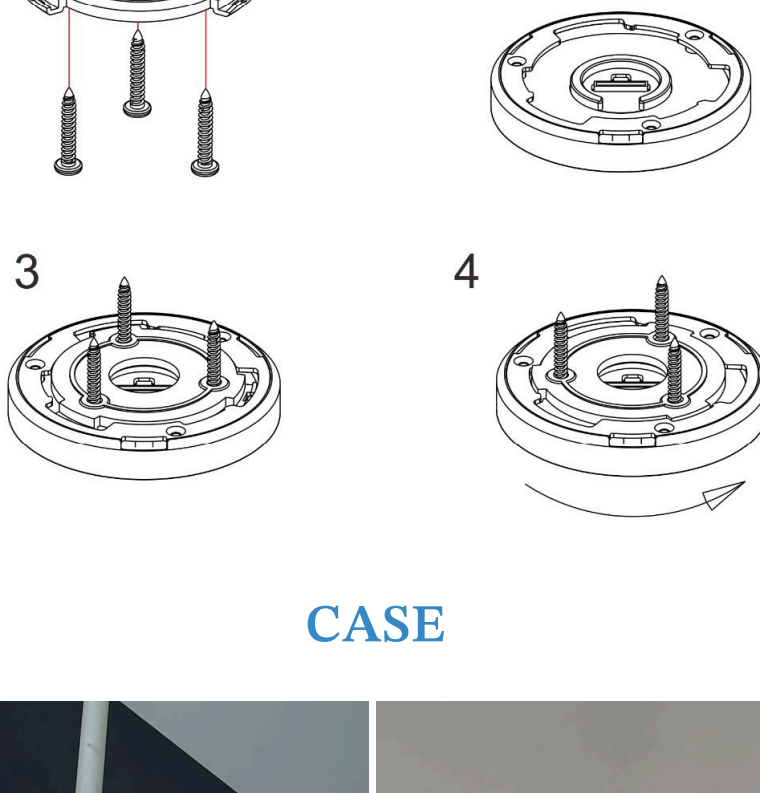

CASE

