



TS-915E

IP PoE Surveillance Microphone

Crystal-Clear Surveillance Sound: Unleash Clarity



MAIN FEATURES

1. Advanced Audio Technology and Processing

- Adaptive dynamic noise reduction to minimize background and environmental noise.
- Built-in DSP digital signal processor for high-definition output.
- All-directional capacitance microphone providing high fidelity, sensitivity, and low noise.
- Automatic AGC circuit for balanced sound output over varying distances.
- Integrated professional SMT audio processor capable of driving active speakers, DVRs, network cameras, etc.
- Ultra-long sound pickup with long transmission distance, strong anti-interference ability, and convenient wiring.



2. Adaptive Sound Management and Protection Features

- Sound volume adjustment according to the on-site environment.
- Built-in modules for lightning strike protection, ESD protection, and power polarity reversal.
- Support for two power supply modes: power adapter and POE.
- Web interface for parameter configuration, video binding, firmware upgrades, and monitoring of audio recordings, device status, and system information.

3. Alarm and Integration Capabilities

- Voice alarm functionality, with the IP Surveillance microphone triggering alarms by identifying specific keywords or abnormal sounds.
- Capability to bind with specific IPC models for audio and video synchronization.
- Alarm information reporting to server platforms for enhanced security and surveillance.

01

SPECIFICATION

MIC PARAMETERS

Sound Pickup Range	2~30M(Adjustable)
Mic Type	Gold Plated Capacitor MIC
Polar Pattern	Directional
SNR(For Circuit)	90dB(@1KHz)
Frequency Response	20Hz~20KHz
Sensitivity	-30dB

GENERAL PARAMETERS

Power Supply	POE IEEE 802.3at/Af/ DC 10V-30V/AC 10V-30V
Protection Circuit	Polarity Reversal / Misconnection Protection/ Lightning Strike Protection/ ESD Protection
Working Temperature	-20°C~60°C
Dimension , Weight	135*71.2*28.2mm , 0.22kg
Accessories	Mouting Bracket *1, Wiring Terminal(3.81-4P) *1, Plastic Expansion *3,Stainless Steel Drill Scrw *2 , Installation Manual *1, Etc.
Warranty	2 Years

02

PORTS DESCRIPTION

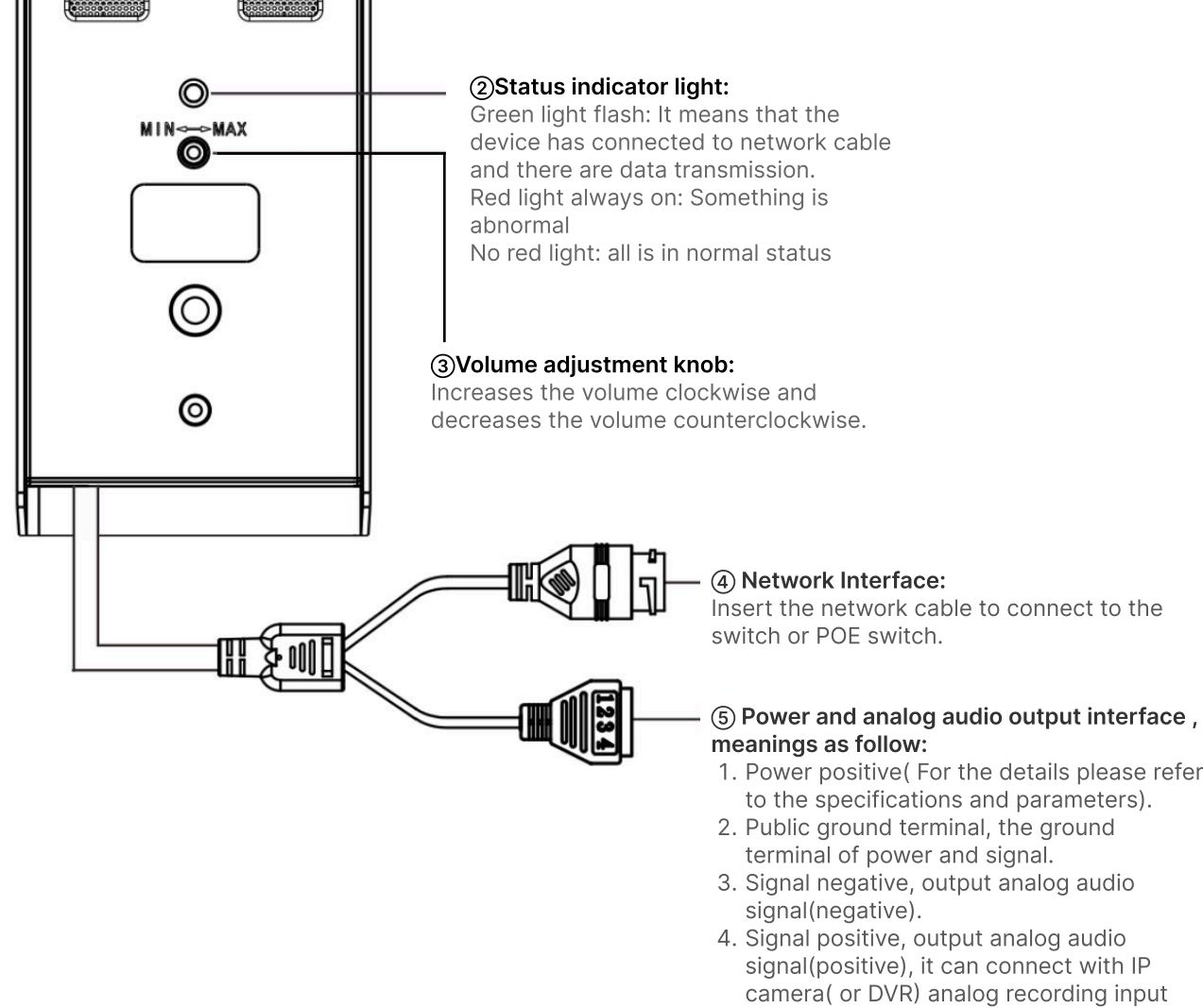

03

APPLICATIONS

Application 1

IP PoE Surveillance Microphone TS-915E supports to bind IP camera and preview audio and video in real time on the Web page . Supports pulling audio and video using RTSP in VLC .

Note: The VLC needs to use 3.0.4 version.

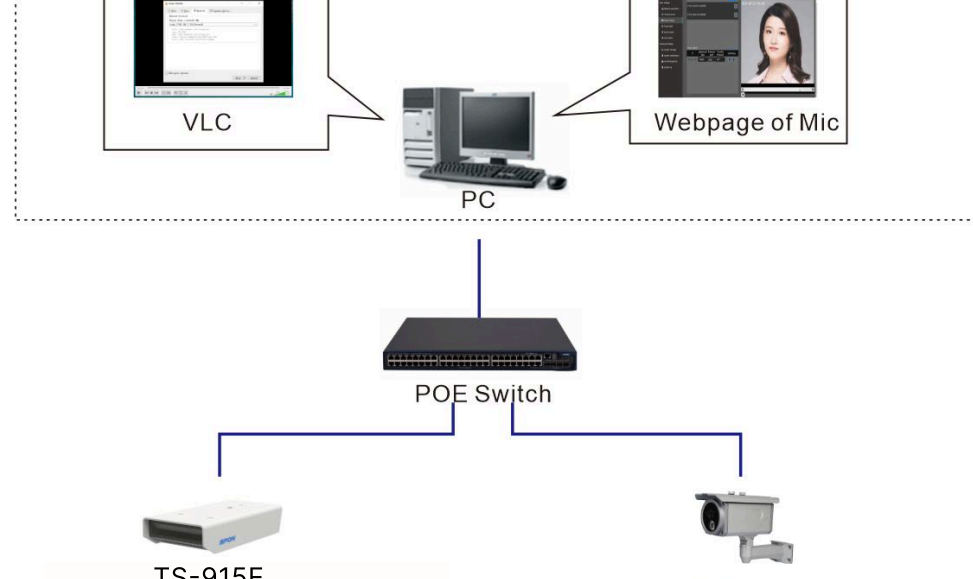

Application 2

IP PoE Surveillance Microphone TS-915E has analog audio output interface which can be connect with digital camera for Synchronous storage of audio and video.

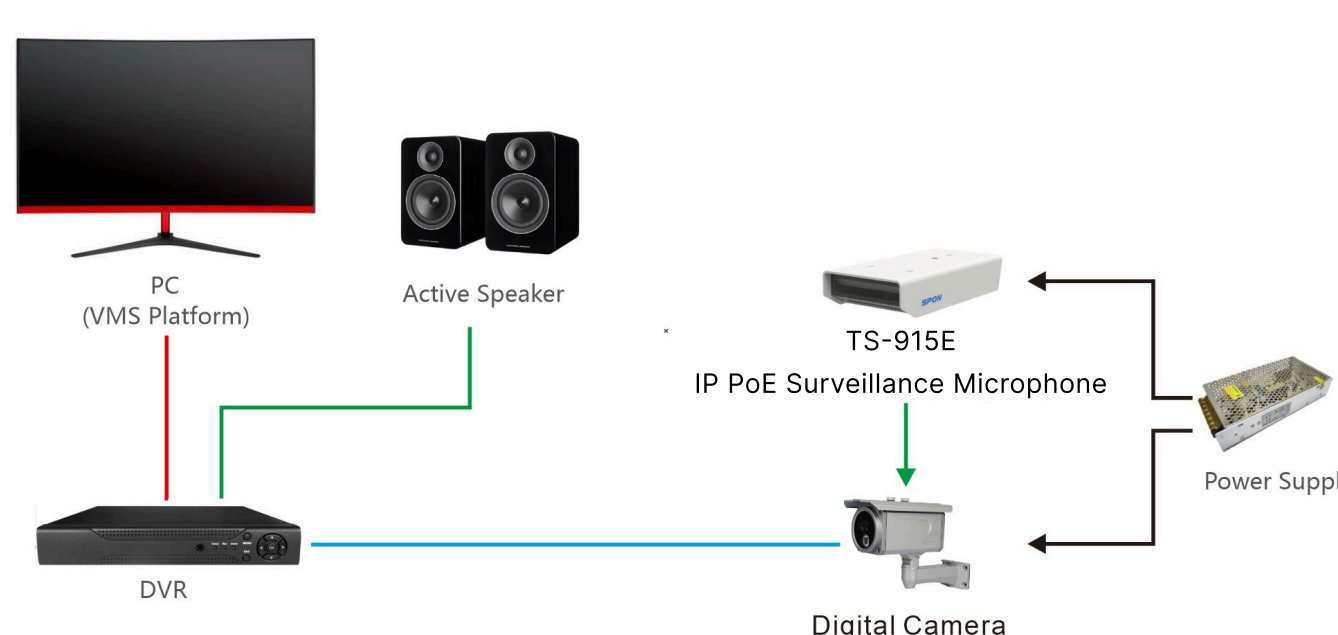

04

INSTALLATION

Installation environment:

Wall, ceiling, monitoring rod and metal column installation.

Installation instructions:

It can be installed vertically or hoisted according to the environment. The bracket will be installed at the bottom of the microphone when in vertical mounting ; For hoisting mounting, the bracket need to be installed on the top of the microphone. Firstly, M6*12 cruciform triple screw was used to fix the microphone and support, and then M3*6 cruciform triple screw was used to fix it, as shown in the below:



Installation mode 1:

First, adjust the angle of microphone, make 3 holes in the wall according to the bracket position, then put the plastic expansion sleeve into the hole, and use 3pcs of half-round head cross screw (ST4*20) to fix the microphone on the wall.

Installation mode 2:

Adjust the angle of microphone, then install in the hole which is installed bracket, and fix the microphone on the monitoring rod or metal pillar with 2pcs drilling screws.

Installation mode 3:

Adjust the angle of microphone, and fix the microphone on the suitable place with the fixing plate and screws.

Installation mode 4:

Installing the equipment on the monitoring rod or others across bracker hole or groove.

